

Arc Weld Studs - Internally Threaded

AIN-RB - TAPPED INTERNALLY THREADED REDUCED BASE - ARC WELD STUDS

Tapped Internally Threaded Reduced Base weld studs are available in mild steel and stainless steel materials. As the majority of these studs are made to each customer's order, the customer can specify all dimensions.

Coarse and fine threads are available in both imperial (UNC-2B and UNF-2B) and ISO metric (Class 6g) sizes. The imperial coarse threads are depicted below (UNC-2B).

Tapped Internally Threaded studs are used to secure components to larger structures and or as a standoff. The reduced weld base diameter may satisfy application needs and or equipment limitations.

For application, dimensional and in stock assistance, please contact Sunbelt Stud Welding.

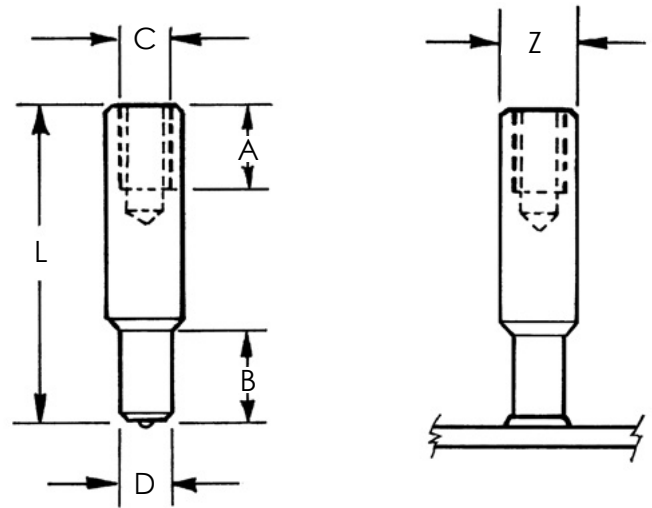

Stud Specifications						Standard Accessories			
Major Diameter	Max. Thread Tap	Min. Thread Depth	Minimum Length*	Base Diameter	Base Length	Ferrule	Foot	Grip	Chuck
Z	C	A	L	D	B	P/N	P/N	P/N	P/N
0.375	1/4 - 20	0.250	0.828	0.250	0.375	F025-LP	B-1N	GN-025	CN-037
0.500	3/8 - 16	0.375	1.015	0.375	0.375	F037-LP	B-1N	GN-037	CN-050
0.625	1/2-13	0.375	1.250	0.500	0.547	F050-LP	B-1N	GN-050	CN-062
0.750	1/2-13	0.375	1.250	0.500	0.547	F050-LP	B-1N	GN-050	CN-075
0.875	5/8-11	0.500	1.703	0.625	0.797	F062-LP	B-2N	GN-062	CN-087
1.000	3/4-10	0.500	1.875	0.750	0.922	F075-LP	B-2N	GN-075	CN-100

Note, the minimum length (L) is reduced when smaller thread sizes are used compared to what is shown.

To order or specify give: Stud Code, Dimensions Z x L, C x A, D x B, Material and Quantity

Example: AIN-RB, .50 x 1.25 with 3/8-16 x .562, RB .375 x .375, (BW), Mild Steel, 1200 pcs.

Specify (L) Length on a Before Weld basis by indicating "BW"

or on an After Weld basis by indicating "AW."

See **Accessories** for accessory detail and **Ferrule Specifications** for ferrule options.

See **Arc Stud Welding - General Information** and **Technical Details** for industry specifications, thread options, Before Weld (BW) length, flux, raw material details, plating options, annealing, load strengths and shipping weights.



website www.sunbeltstudwelding.com email info@sunbeltstudwelding.com
6381 Windfern Road, Houston, TX 77040 telephone 1.800.462.9353 - Houston 713.939.8903 fax 713.939.9013