

Arc Weld Studs - Externally Threaded

RB - THREADED REDUCED BASE WELD STUDS - TECHNICAL DETAILS

TRB weld studs are available in mild steel and stainless steel materials. RB studs are most often made to each customer's order.

TRB studs have a smaller weld base diameter than TP, TF and TFB studs and thus produce a smaller flash diameter. TRB studs permit smaller clearance holes in your design. The load strengths for TRB studs are determined by the weld base diameter.

For application, dimensional and in stock assistance, please contact Sunbelt Stud Welding.

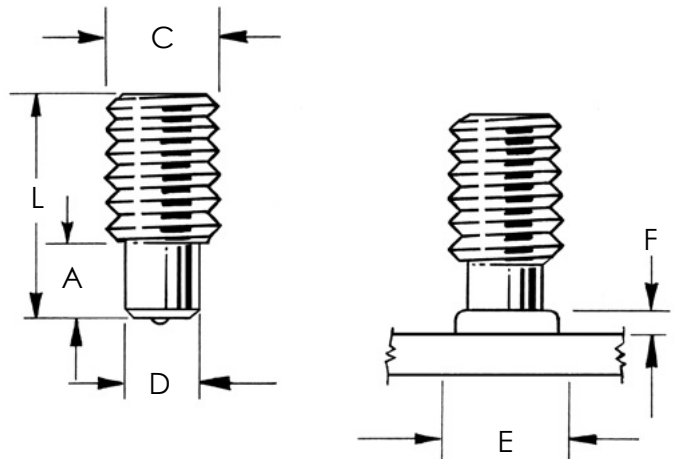

Stud Specifications						Standard Accessories			
Thread Size	Minimum Length	Base Diameter	Base Length	Flash Dimensions		Ferrule	Foot	Grip	Chuck
C	L	D	A	E	F	P/N	P/N	P/N	P/N
1/4 - 20	0.750	0.187	0.187	0.266	0.125	F025-TB	B-1N	GN-025	CN-025
5/16 - 18	0.750	0.246	0.187	0.313	0.125	F031-TB	B-1N	GN-031	CN-031
3/8 - 16	0.750	0.312	0.375	0.422	0.125	F037-R	B-1N	GN-037	CN-037
7/16 - 14	0.875	0.375	0.375	0.500	0.125	F043-R	B-1N	GN-043	CN-043
1/2 - 13	1.000	0.437	0.437	0.563	0.156	F050-R	B-1N	GN-050	CN-050
5/8 - 11	1.250	0.500	0.547	0.609	0.172	F062-R	B-2N	GN-062	CN-062
3/4 - 10	1.500	0.625	0.797	0.766	0.281	F075-R	B-2N	GN-075	CN-075
7/8 - 9	1.500	0.750	0.922	0.938	0.328	FO75-F	B-3N	GN-075	CN-087
1 - 8	1.750	0.875	1.078	1.063	0.344	F087-F	B-3N	GN-087	CN-100

To order or specify give: Stud Code, Thread size, Length, Unthreaded length, Material and Quantity

Example: RB, 1/2-13 x 1.50, .437, (BW), Mild Steel, 2500 pcs.

Specify (L) Length on a Before Weld basis by indicating "BW" or on an After Weld basis by indicating "AW."

See **Accessories** for accessory detail and **Ferrule Specifications** for ferrule options.

See **Arc Stud Welding – General Information** and **Technical Details** for industry specifications, thread options, Before Weld (BW) length, flux, raw material details, plating options, annealing, load strengths and shipping weights.

